

LASER[®]

Part No. 4346

Engine Timing Tool Kit

VAG 1.4, 1.9, 2.0 TDI PD
1.2, 1.6, 2.0 TDI CR

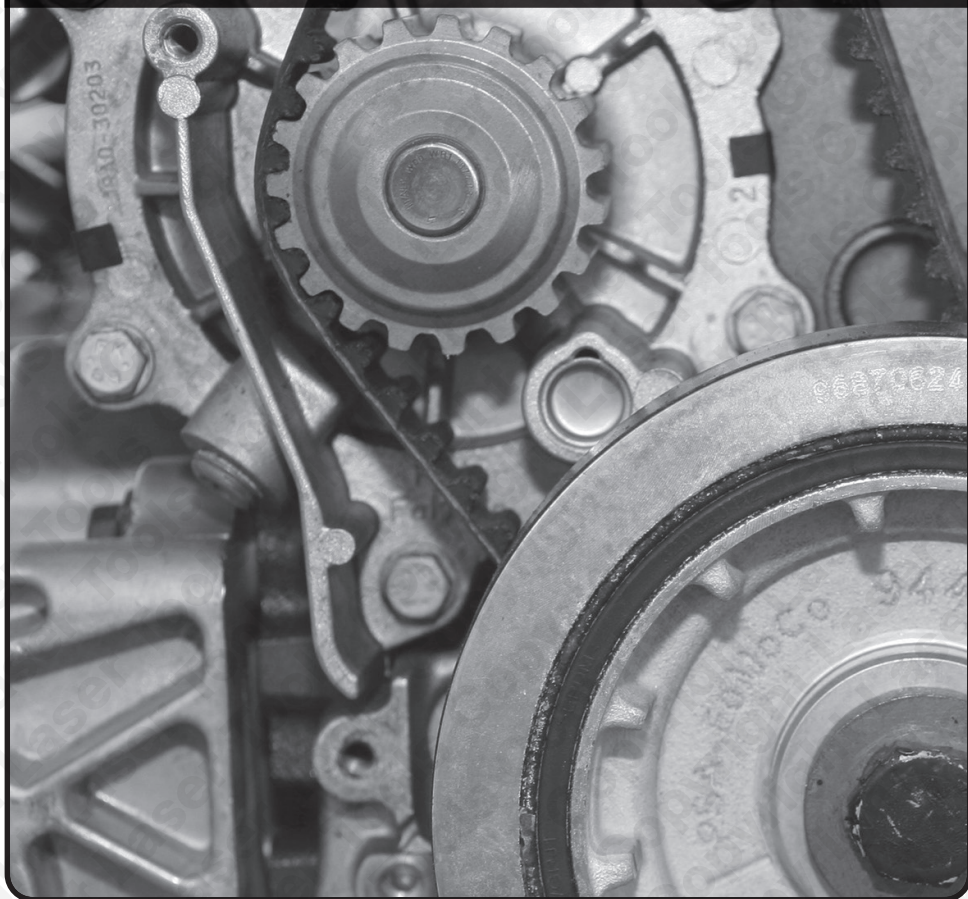

www.lasertools.co.uk

Introduction

Provides the essential camshaft, crankshaft and tensioner setting tools for the popular VAG designed 1.4, 1.9 and 2.0 TDi PD and 1.2, 1.6 and 2.0 TDI CR diesel engines from 2002 to 2015. See engine code application list.

Plan Layout

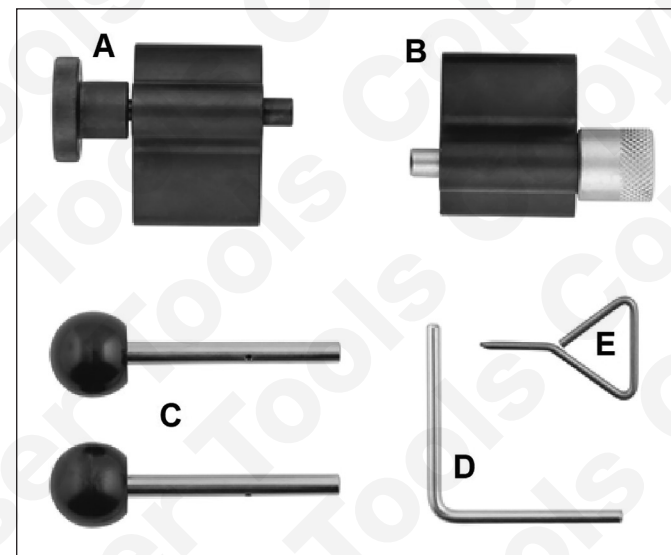

Ref.	Comp. Code	OEM Ref.	Description
A	C157	T10050	Crankshaft Locking Tool
B	C304	T10100	Crankshaft Locking Tool
C	C216	VW3359, T20102	Camshaft Pulley Locking Pins
D	C283	T10060, T10060A	Tensioner Pin, Auxiliary Drive Belt
E	C282	T10115	Tensioner Pin, Cambelt

Applications

NOTE: Common Rail engines also require Part No. 4703 - Tensioner Tool Set 2pc

Capacity	Engine Code
1.4 TDI PD	AMF*, ATL, BAY, BHC, BMS, BNM, BNV, BWB
1.9 TDI PD	AJM*, ANU*, ARL*, ASZ*, ATD*, AUJ*, AVB*, AVF*, AWP*, AXB, AXC, AXR*, BJB, BKC, BLS, BLT, BMT, BPX, BPZ, BRB, BRM, BRR, BRS, BSV, BSW*, BTB*, BUK, BVK*, BXE, BXF, BXJ
2.0 TDI PD	AZV, BGW, BHW, BKD, BKP, BLB, BMA, BMM, BMN, BMP, BMR, BNA, BPW, BRC, BRD, BRE, BRF, BRT, BSS, BST, BUY, BUZ, BVA, BVE, BVF, BVG, BVH, BWV
1.2 TDI CR	CFWA
1.6 TDI CR	CAYA, CAYB, CAYC, CAYD, CAYE, CLNA
2.0 TDI CR	CAAA, CAAB, CAAC, CAAD, CAAE, CAGA, CAGB, CAGC, CAHA, CAHB, CBAA, CBAB, CBAC, CBBA, CBBB, CBDA, CBDB, CBDC, CCHA, CCHB, CDBA, CDCA, CEGA, CFCA, CFFA, CFFB, CFFD, CFFE, CFGB, CFGC, CFGD, CFHA, CFHB, CFHC, CFHD, CFHE, CFHF, CFJA, CFJB, CGLA, CGLB, CGLC, CGLD, CGLE, CJAA, CJCA, CJCB, CJCC, CJCD, CKTB, CKTC, CKUB, CKUC, CLCA, CLCB, CLJA, CLLA, CLLB, CLSC, CMEA, CMFA, CMFB, CMGA, CMGB, CNEA, CNFA, CNFB, CSHA, CSLA, CSLB, CSNA

*except hydraulic damped tensioner

Always refer to the website for most up to date applications:
www.lasertools.co.uk/product/4346

Instructions

Due to the number of engines covered it is not possible to give full vehicle specific instructions. Please refer to OEM instructions or other reputable aftermarket workshop data. The following instructions are for guidance only.

The use of these engine timing tools is purely down to the user's discretion and The Tool Connection Ltd cannot be held responsible for any damage caused what so ever.

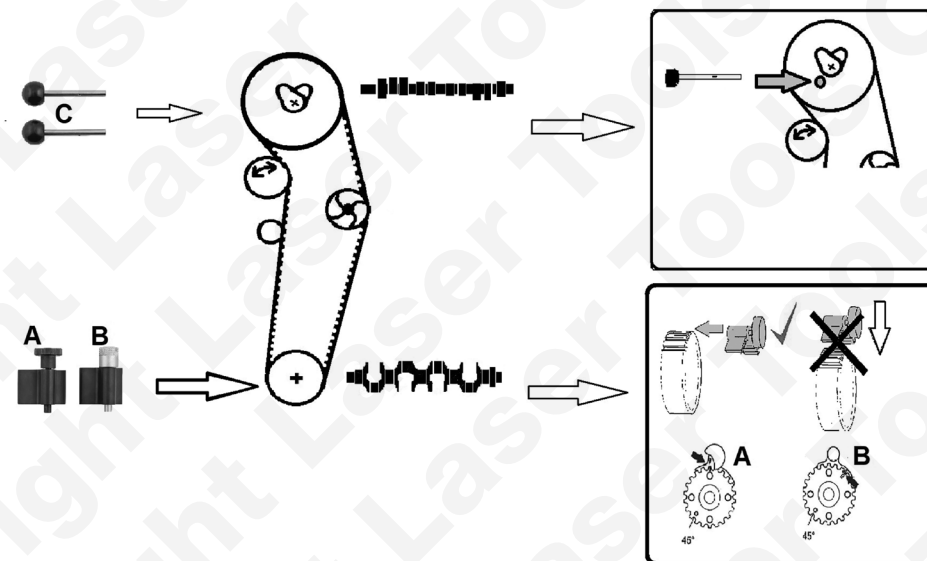

Instructions

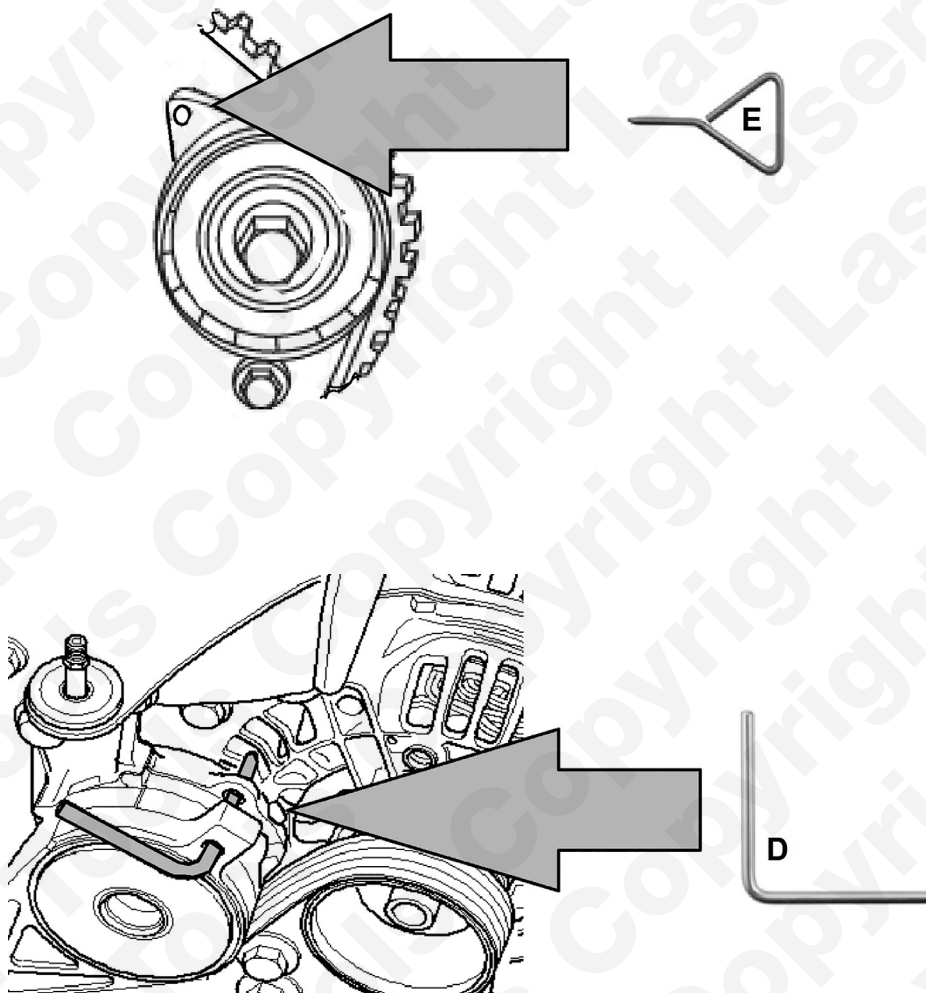

Safety Precautions – Please read

Incorrect or out of phase engine timing can result in damage to the valves. The Tool Connection cannot be held responsible for any damage caused by using these tools in anyway.

- Disconnect the battery earth leads (check radio code is available).
- Remove spark or glow plugs to make the engine turn easier.
- Do not use cleaning fluids on belts, sprockets or rollers.
- Always make a note of the route of the auxiliary drive belt before removal.
- Turn the engine in the normal direction (clockwise unless stated otherwise).
- Do not turn the camshaft, crankshaft or diesel injection pump once the timing belt/chain has been removed (unless specifically stated).
- Do not use the timing chain to lock the engine when slackening or tightening crankshaft pulley bolts.
- Mark the direction of the chain before removing.
- It is always recommended to turn the engine slowly, by hand and to re-check the camshaft and crankshaft timing positions.
- Crankshafts and camshafts may only be turned with the chain drive mechanism fully installed.
- Do not turn crankshaft via camshaft or other gears.
- Check the diesel injection pump timing after replacing the chain.
- Observe all tightening torques.
- Always refer to the vehicle manufacturer's service manual or a suitable proprietary instruction book.
- Do not work on or under a vehicle supported only by a jack. If lifting the vehicle with a jack it must be securely supported on safety axle stands.
- Inspect the tools for worn and broken parts before use.
- Wear appropriate safety equipment.
- Use common sense and caution at all times.



Safety First. Be Protected.

Our products are designed to be used correctly and with care for the purpose for which they are intended. No liability is accepted by the Tool Connection for incorrect use of any of our products, and the Tool Connection cannot be held responsible for any damage to personnel, property or equipment when using the tools. Incorrect use will also invalidate the warranty.

If applicable, the applications database and any instructional information provided has been designed to offer general guidance for a particular tool's use and while all attention is given to the accuracy of the data no project should be attempted without referring first to the manufacturer's technical documentation (workshop or instruction manual) or the use of a recognised authority such as Autodata.

It is our policy to continually improve our products and thus we reserve the right to alter specifications and components without prior notice. It is the responsibility of the user to ensure the suitability of the tools and information prior to their use.



4346_Instructions_V6



www.lasertools.co.uk

Guarantee



Distributed by The Tool Connection Ltd
Kington Road, Southam, Warwickshire CV47 0DR
T +44 (0) 1926 815000 F +44 (0) 1926 815888
info@toolconnection.co.uk www.toolconnection.co.uk

If this product fails through faulty materials or workmanship, contact our service department direct on: **+44 (0) 1926 816166**. Normal wear and tear are excluded as are consumable items and abuse.

www.lasertools.co.uk